

BPA Rates Hearing Room

1201 NE Lloyd Blvd., Suite 200, Portland, OR 97232 (2nd Floor)

Note: There are no security procedures to attend meetings at the BPA Rates Hearing Room.

Wi-Fi is available.

Parking Information

BPA does not recommend parking in the Lloyd Center mall parking lot; you risk being towed. BPA cannot validate any parking.

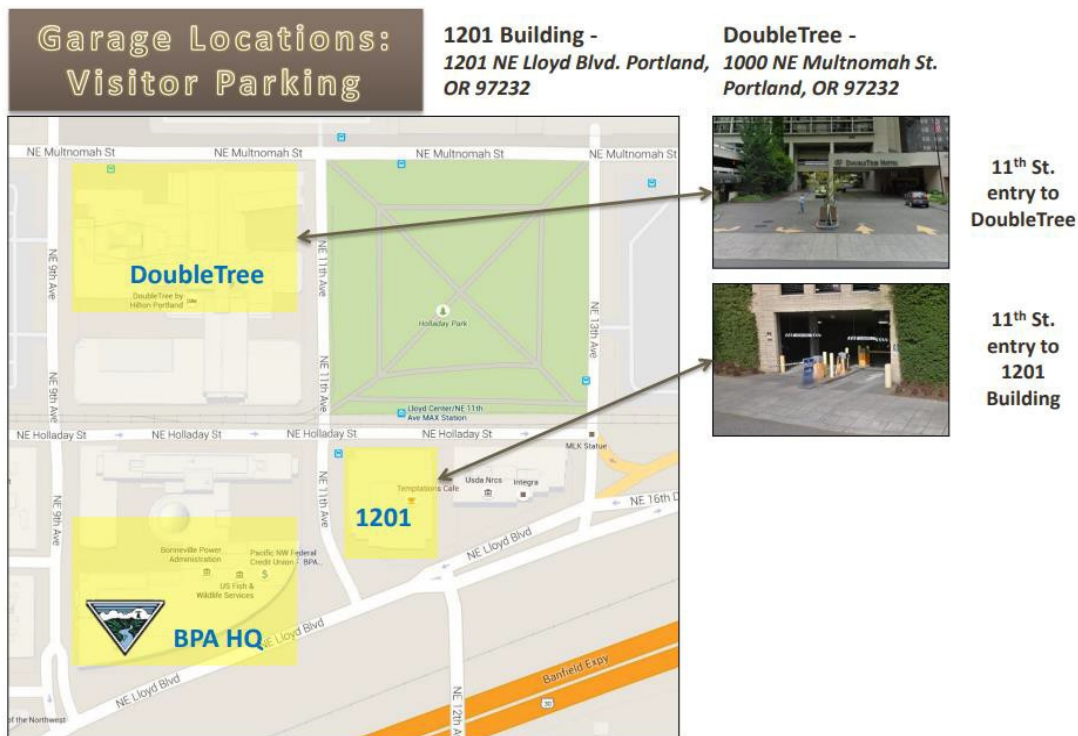

Nearby Dining Options

- Xocalo - 1130 NE Holladay St
- Lloyd Center food court - 1405 Lloyd Center: Chicken Connection, Dicky's BBQ Pit
- J Café - 533 NE Holladay St
- E-San Thai food cart - Oregon Square Park, 800 NE Holliday St
- Café Yumm - 1010 NE 7th Ave
- Burgerville - 1135 NE MLK, Jr Blvd
- Red Robin - 1139 NE Grand Ave
- Metropolitan Tavern - 1021 NE Grand Ave, Suite 600
- Chipotle - 704 NE Weidler
- Burger King - 632 NE Weidler St
- Taco Bell - 725 NE Weidler
- Wendy's 1421 - NE Grand Ave
- Frank's Noodle - House 822 NE Broadway
- Five Guys - 1200 NE Broadway
- Jimmy John's - 1139 NE Broadway
- Aztec Willie's Taqueria - 1501 NE Broadway
- McMenamins Broadway Pub - 1504 NE Broadway Ave
- McDonald's - 1520 NE Grand Ave

Rates Hearing Room Webex Instructions

You are welcome to connect to the meeting Webex while in the Rates Hearing Room, but your Webex audio must be fully disconnected (not just on mute).

As you join the meeting, there is an option to adjust your audio settings in the control panel at the bottom of your screen:

1. Click the “Audio: Use computer audio” button.

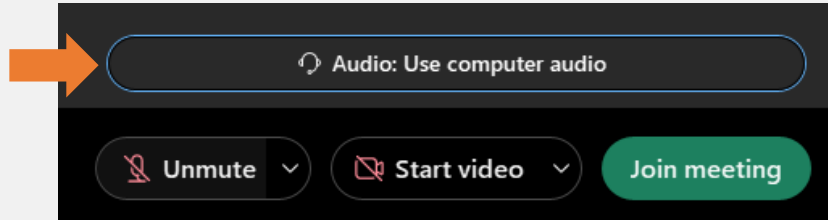

2. From the pop-up menu, select “Don’t connect to audio.”

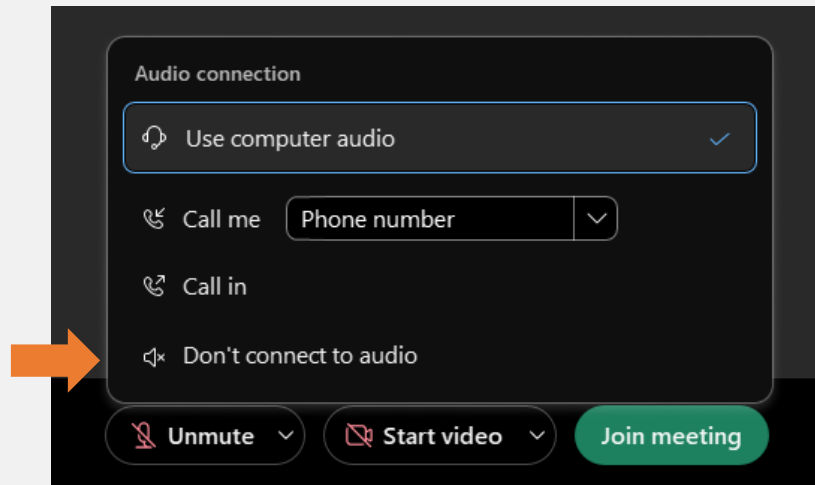

If you have already joined the Webex with audio connected:

1. In the Webex control panel for audio, click “Switch Audio.”
2. Select “Disconnect.”
3. You will know you are successful when your control panel shows a button to “Connect.”

